

# SHIMANO

STELLA **S**A-RB

STL-SW8000HG

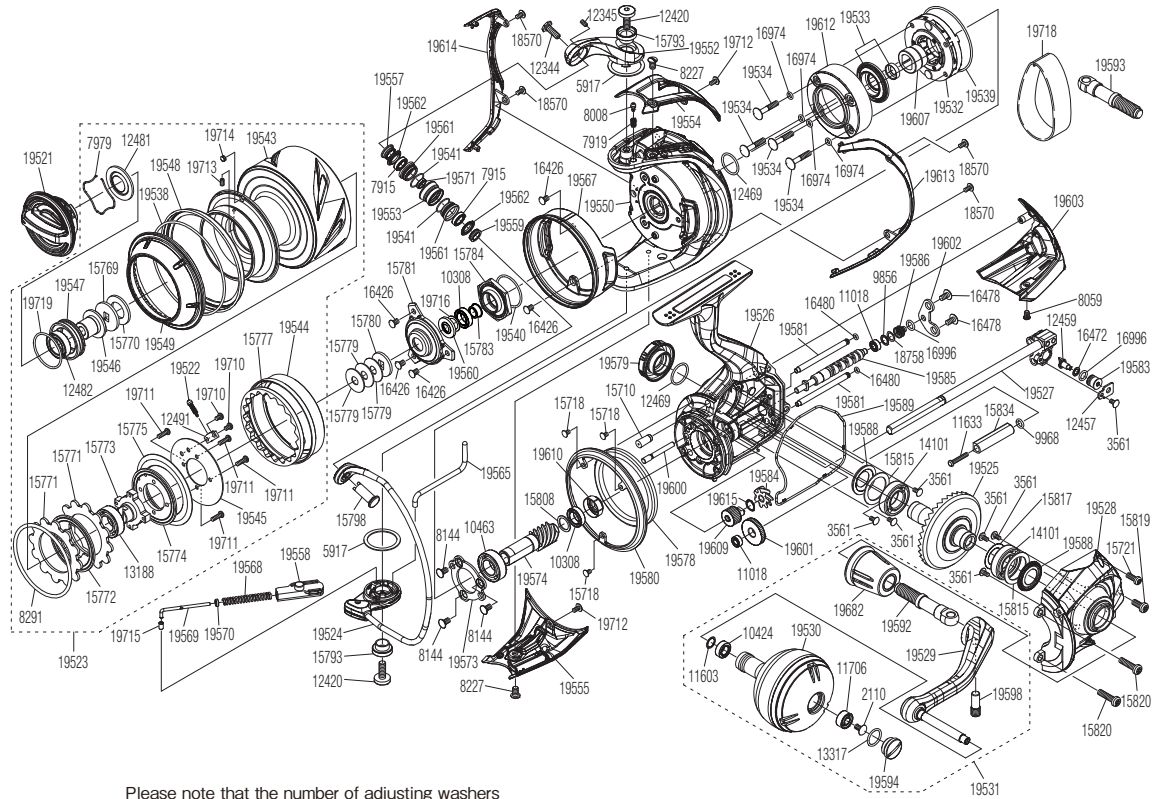

Please note that the number of adjusting washers may not be the same as shown in the exploded views. (Adjustment will vary with each individual product.)  
 RD 19532 Roller Clutch Assembly please send the equipment out to after-sales service for replacement of the roller clutch assembly. Malfunctions and other problems resulting from disassembly are not covered by warranty. The customer shall take full responsibility for any issues arising from disassembling this product.

(51SF24P082X)

Part No.	Description	Part No.	Description	Part No.	Description
RD 2110	Screw	RD15817	Washer	RD19570	Spring Guide A Support Collar
RD 3561	Screw	RD15819	Screw	RD19571	Collar
RD 5917	Washer	RD15820	Screw	RD19573	Bearing Retainer
RD 7915	Ball Bearing	RD15834	Collar	RD19574	Pinion Gear
RD 7919	Click Spring	RD16426	Screw	RD19578	Friction Ring
RD 7979	Retainer	RD16472	Washer	RD19579	Handle Screw Cap
RD 8008	Click Pin	RD16478	Screw	RD19580	Body Flange Ring
RD 8059	Screw	RD16480	O Ring	RD19581	Oscillating Guide
RD 8144	Screw	RD16974	O Ring	RD19583	Oscillating Slider Bushing
RD 8227	Screw	RD16996	O Ring	RD19584	Idle Gear
RD 8291	O Ring	RD18570	Screw	RD19585	Worm Shaft
RD 9856	Washer	RD18758	Washer	RD19586	Bushing
RD 9968	O Ring	RD19521	Drag Knob Assembly	RD19588	Bearing Water Proof
RD10308	Ball Bearing	RD19522	Drag Click Assembly	RD19589	Body Seal
RD10424	Ball Bearing	RD19523	Spool Assembly	RD19592	Handle Shaft
RD10463	Ball Bearing	RD19524	Bail Assembly	RD19594	Handle Knob Seal
RD11018	Ball Bearing	RD19525	Drive Gear Assembly	RD19598	Screw
RD11603	Washer	RD19526	Body Assembly	RD19600	Idle Gear Shaft
RD11633	Screw	RD19527	Main Shaft Assembly	RD19601	Idle Gear (Large)
RD11700	Ball Bearing	RD19528	Side Cover Assembly	RD19602	Worm Shaft Retainer
RD12344	Screw	RD19529	Handle Shank Assembly	RD19603	Rear Protector
RD12345	Set screw	RD19530	Handle Knob Assembly	RD19607	Roller Clutch Inner
RD12420	Screw	RD19531	Handle Assembly	RD19609	Idle Gear (Small)
RD12457	Oscillating Pawl Cover	RD19532	Roller Clutch Assembly	RD19610	Bushing
RD12459	Oscillating Pawl	RD19533	Roller Clutch Waterproof Assembly	RD19612	Clutch Water Proof Cover
RD12469	O Ring	RD19534	Screw	RD19613	Rotor Guard A
RD12481	Waterproof Sheet	RD19538	O Ring	RD19614	Rotor Guard B
RD12482	Ball Bearing	RD19539	O Ring	RD19615	Washer
RD12491	Spring Holder	RD19540	O Ring	RD19682	Handle Shaft Cover Assembly
RD13188	Ball Bearing	RD19541	O Ring	RD19710	Screw
RD13317	O Ring	RD19543	Spool Shell	RD19711	Screw
RD14101	Ball Bearing	RD19544	Drag Cover	RD19712	Screw
RD15710	Body Flange Seal	RD19545	Drag Plate Washer	RD19713	Set screw
RD15718	Screw	RD19546	Bearing Support	RD19714	Spool Ring Pin
RD15721	Screw	RD19547	Bearing Bushing	RD19715	Bail Spring Guide A Bush
RD15769	Key Washer	RD19548	Spool Ring	RD19716	Washer
RD15770	Drag Washer A	RD19549	Collar	RD19719	O Ring
RD15771	Drag Washer B	RD19550	Rotor		
RD15772	Drag Disk A	RD19552	Bail Arm		
RD15773	Bearing Bushing	RD19553	Line Roller		
RD15774	Drag Disk B	RD19554	Bail Spring Cover		
RD15775	Spool Bearing Water Proof	RD19555	Bail Hold Support Guard		
RD15777	Drag Click Ratchet	RD19557	Line Roller Plate		
RD15779	Spool Washer	RD19558	Bail Spring Guide B		
RD15780	Spool Support	RD19559	Collar		
RD15781	Retainer	RD19560	Bearing Water Proof		
RD15783	Spacer	RD19561	Bushing		
RD15784	Rotor Nut	RD19562	Line Roller Seal		
RD15793	Collar	RD19565	Bail Trip Lever		
RD15798	Line Roller Support	RD19567	Rotor Brim		
RD15808	Washer	RD19568	Bail Spring	RD19718	Belt (M) (accessory)
RD15815	Washer	RD19569	Bail Spring Guide A	RD19593	Handle Shaft (Right) (accessory)