

GRX Front Wheel
WH-RX570-TL-F12-700C For Disc Brake

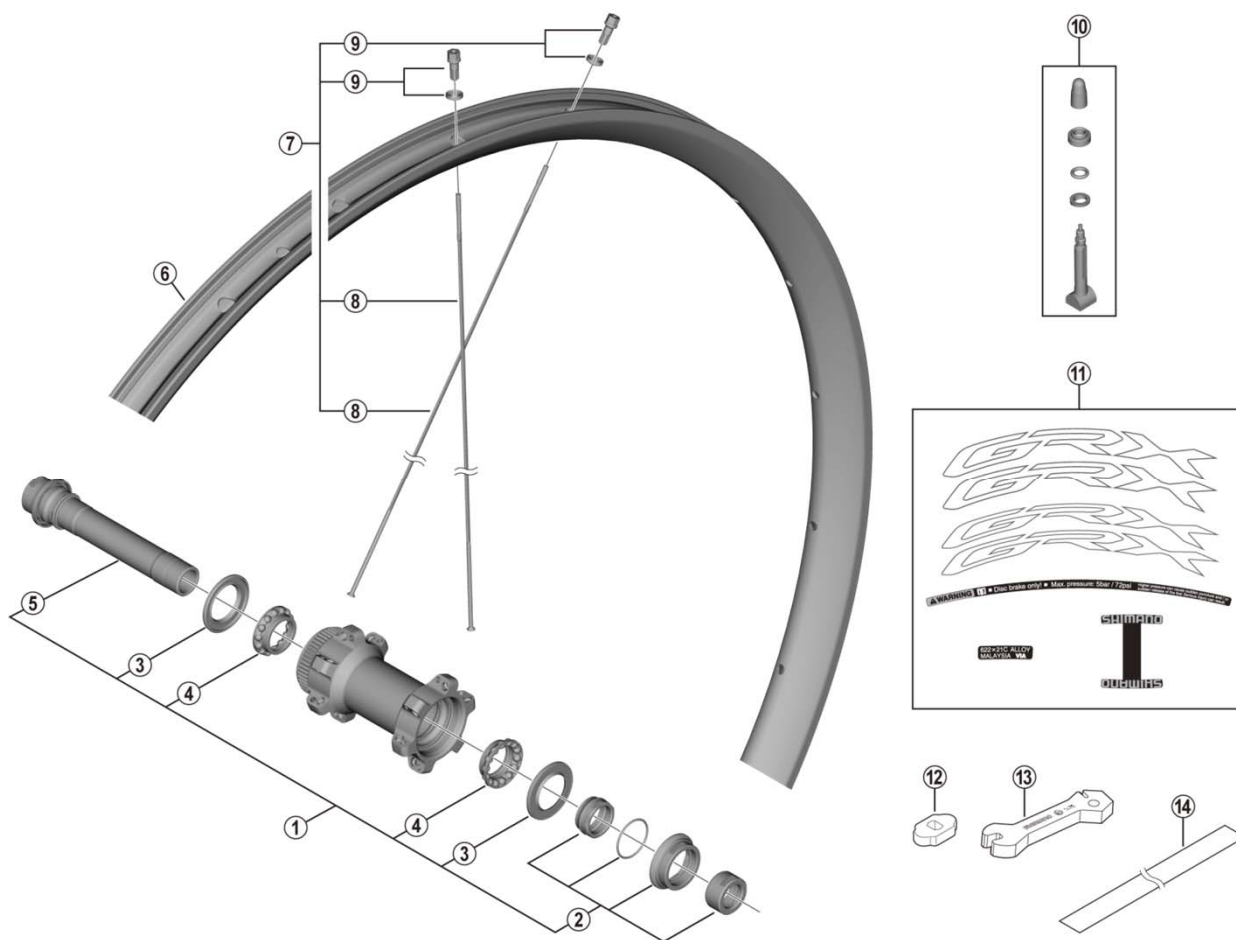

• Over Lock Nut Dimension: 100 mm (3-15/16")

ITEM NO.	SHIMANO CODE NO.	DESCRIPTION	INTERCHANGE-ABILITY		
1	Y0H198010	Complete Hub Axle	B		
2	Y0H198020	Right Hand Lock Nut	B		
3	Y26D10000	Seal Ring	A		
4	Y0AY98030	Ball Retainer (5/32")	A		
5	Y0H198030	Hub Axle Unit	B		
6	-	Rim (24H)			
7	-	Spoke Unit {Spoke (296 mm x 24 pcs.) / Nipple (24 pcs.) / Rim Washer (24 pcs.)}			
8	Y0H1S1000	Spoke (296 mm)			
9	Y0H198040	Nipple & Rim Washer			
10	Y0D298060	Valve Unit			
11	Y0H198050	Rim Sticker Unit			
12	Y4RJ10000	VALVE TOOL			
13	Y4SY11000	NIPPLE WRENCH 3.75	A		
14	Y0H105810	TUBELESS TAPE (POLYIMIDE)			

A: Same parts.

B: Parts are usable, but differ in materials, appearance, finish, size, etc.

Absence of mark indicates non-interchangeability.

Specifications are subject to change without notice.

Sep.-2019-4572

© Shimano Inc. ITP

SHIMANO