

# WH-RS770-C30-TL-F12

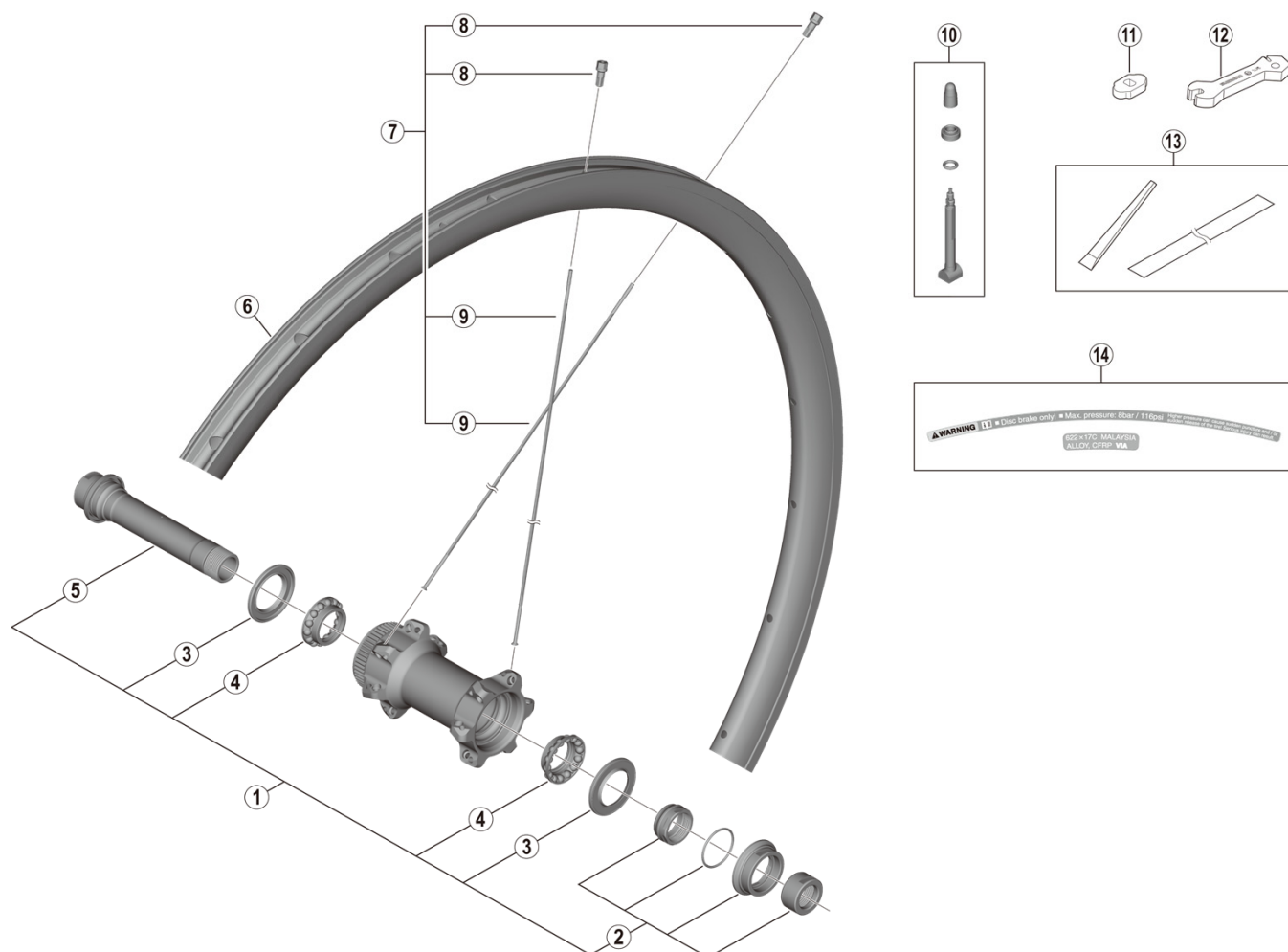

HB-RS770

- **Over Lock Nut Dimension: 100 mm**

ITEM NO.	SHIMANO CODE NO.	DESCRIPTION	INTERCHANGE-ABILITY		
1	Y2BW98010	Complete hub axle	A		
2	Y2BW98020	Right hand lock nut unit	A		
3	Y26D10000	Seal ring	A		
4	Y0AY98030	Ball retainer (5/32")	A		
5	Y2BW98030	Hub axle unit	A		
6	EWHRIMZ2F5P	Rim {24H}			
7	EWHSPOKEY2739	Spoke unit {spoke (289.5 mm x 24 pcs.) / nipple (24 pcs.)}			
8	Y4SYN1000	Nipple			
9	Y0D4S1000	Spoke (289.5 mm)			
10	Y0D498010	Valve unit			
11	Y4RJ10000	Valve tool			
12	Y4SY11000	Nipple wrench 3.75			
* 13	Y0AN98040	Tubeless tape with spatula			
14	Y0D498020	Rim sticker unit			

A: Same parts.

B: Parts are usable, but differ in materials, appearance, finish, size, etc.

Absence of mark indicates non-interchangeability.

Specifications are subject to change without notice.

Jun.-2021-4238C

© Shimano Inc. I

# SHIMANO