

Rear Wheel (MTB 12-speed)

# WH-MT620-TL-R12-B-29 For Disc Brake

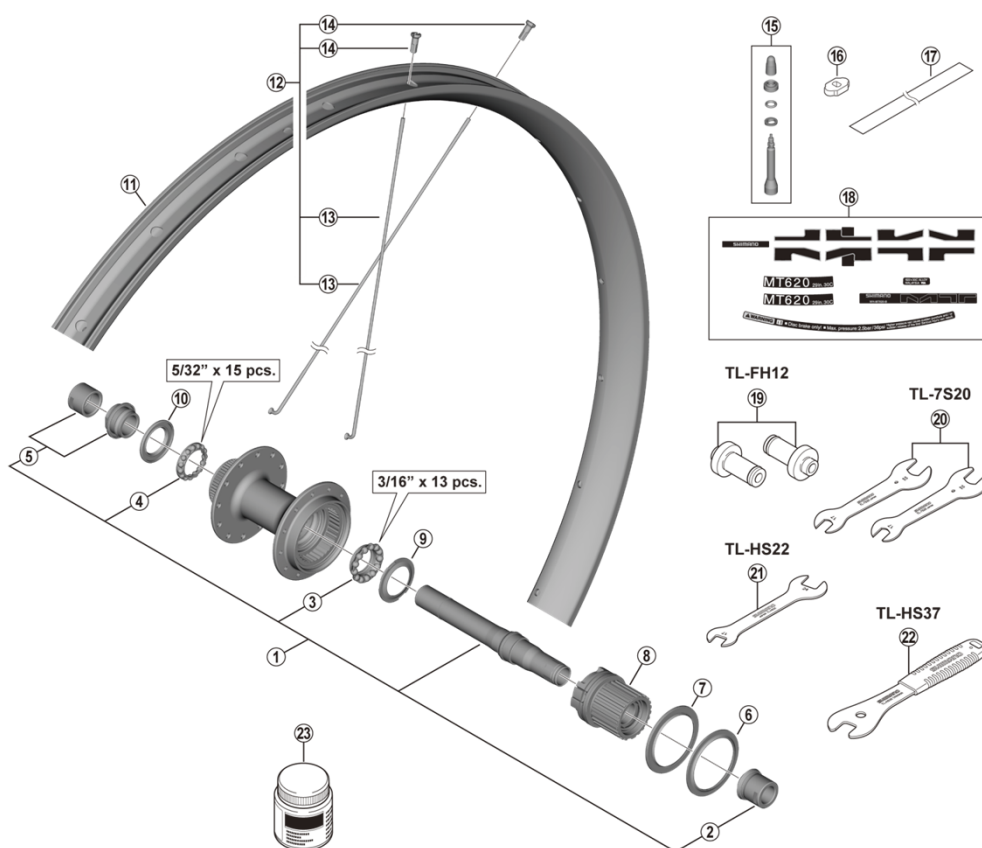

WH-MT501-CL-R12-B-29

• Over Lock Nut Dimension: 148 mm (5-13/16")

ITEM NO.	SHIMANO CODE NO.	DESCRIPTION	INTERCHANGEABILITY
1	Y0KD98010	Complete Hub Axle	A
2	Y0KD98020	Right Hand Cap Unit	A
3	Y3G198030	Right Hand Ball Retainer (3/16" x 13)	A
4	Y0CJ98030	Ball Retainer (5/32" x 15)	A
5	Y0KD98030	Left Hand Lock Nut & Cone w/Dust Cover	A
6	Y3GD10000	Outer Seal Cap	A
7	Y3GD11000	Outer Seal Ring	A
8	Y0KD98040	Freewheel Body Unit	A
9	Y3G112000	Inner Cover	A
10	Y26D10000	Seal Ring	A
11	-	Rim {24H}	
12	-	Spoke Unit {Spoke (288 mm x 24 pcs.) / Nipple (24 pcs.)}	
13	Y0KRS1000	Spoke (288 mm)	
14	Y012Y3352	Nipple	A
15	Y0KL98010	Valve Unit	
16	Y4RJ10000	Valve Tool	A
17	Y0KP00010	Tubeless Tape	
18	Y0KR98010	Rim Sticker Unit	
18	Y0KR98020	Rim Sticker Unit (Red)	
18	Y0KR98030	Rim Sticker Unit (Blue)	
18	Y0KR98040	Rim Sticker Unit (Orange)	
18	Y0KR98050	Rim Sticker Unit (Green)	
18	Y0KR98060	Rim Sticker Unit (Yellow)	
18	Y0KR98070	Rim Sticker Unit (Gray)	
19	Y13098011	TL-FH12 Hub Setting Tool for 12 mm Thru-axle	A
20	Y13098900	TL-7S20 Hub Spanner (17 mm x 22 mm) 2 pcs.	A
21	Y3C227000	TL-HS22 Hub Spanner (17 mm x 24 mm)	A
22	Y23098030	TL-HS37 Hub Spanner 17 mm	A
23	Y3B980000	Grease for FREEHUB 50g	A

A: Same parts.

B: Parts are usable, but differ in materials, appearance, finish, size, etc.

Absence of mark indicates non-interchangeability.

Specifications are subject to change without notice.

Nov.-2019-4569

© Shimano Inc. ITP

# SHIMANO