

Rear Wheel (MTB 12-speed)

WH-MT501-CL-R12-B-29 For Disc Brake

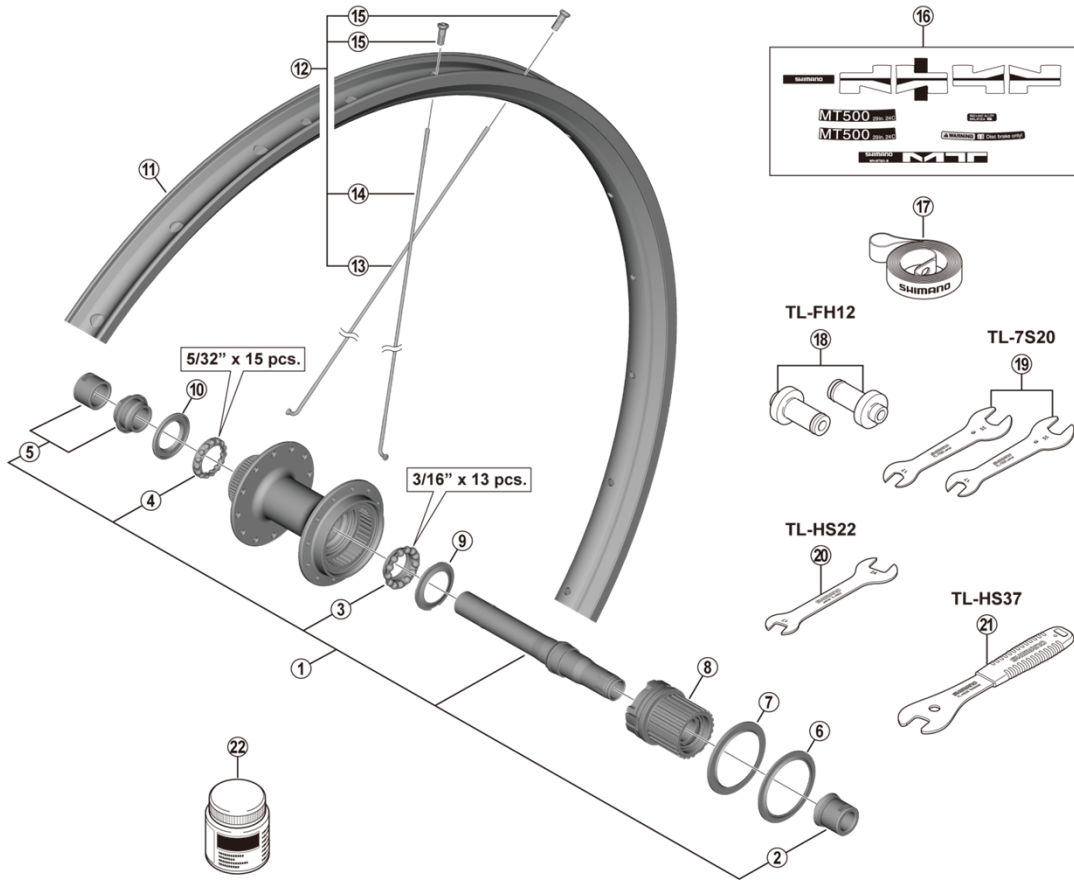

WH-MT620-TL-R12-B-29

• Over Lock Nut Dimension: 148 mm (5-13/16")

ITEM NO.	SHIMANO CODE NO.	DESCRIPTION	INTERCHANGEABILITY	
1	Y0KD98010	Complete Hub Axle	A	
2	Y0KD98020	Right Hand Cap Unit	A	
3	Y3G198030	Right Hand Ball Retainer (3/16" x 13)	A	
4	Y0CJ98030	Ball Retainer (5/32" x 15)	A	
5	Y0KD98030	Left Hand Lock Nut & Cone w/Dust Cover	A	
6	Y3GD10000	Outer Seal Cap	A	
7	Y3GD11000	Outer Seal Ring	A	
8	Y0KD98040	Freewheel Body Unit	A	
9	Y3G112000	Inner Cover	A	
10	Y26D10000	Seal Ring	A	
11	-	Rim {24H}		
12	-	Spoke Unit {Spoke (288 mm x 12 pcs. / 286.5 mm x 12 pcs.) / Nipple (24 pcs.)}		
13	Y0KRS1000	Spoke (288 mm)		
14	Y0KFS3000	Spoke (286.5 mm)		
15	Y012Y3352	Nipple		
16	Y0KF98010	Rim Sticker Unit		
16	Y0KF98020	Rim Sticker Unit (Red)		
16	Y0KF98030	Rim Sticker Unit (Blue)		
16	Y0KF98040	Rim Sticker Unit (Orange)		
16	Y0KF98050	Rim Sticker Unit (Green)		
16	Y0KF98060	Rim Sticker Unit (Yellow)		
16	Y0KF98070	Rim Sticker Unit (Gray)		
17	Y00X00020	Rim Tape 25-622		
18	Y13098011	TL-FH12 Hub Setting Tool for 12 mm Thru-axle	A	
19	Y13098900	TL-7S20 Hub Spanner (17 mm x 22 mm) 2 pcs.	A	
20	Y3C227000	TL-HS22 Hub Spanner (17 mm x 24 mm)	A	
21	Y23098030	TL-HS37 Hub Spanner 17 mm	A	
22	Y3B980000	Grease for FREEHUB 50g	A	

A: Same parts.

B: Parts are usable, but differ in materials, appearance, finish, size, etc.

Absence of mark indicates non-interchangeability.

Specifications are subject to change without notice.

Nov.-2019-4556

© Shimano Inc. ITP

SHIMANO