

Front Wheel WH-MT500-CL-F-29

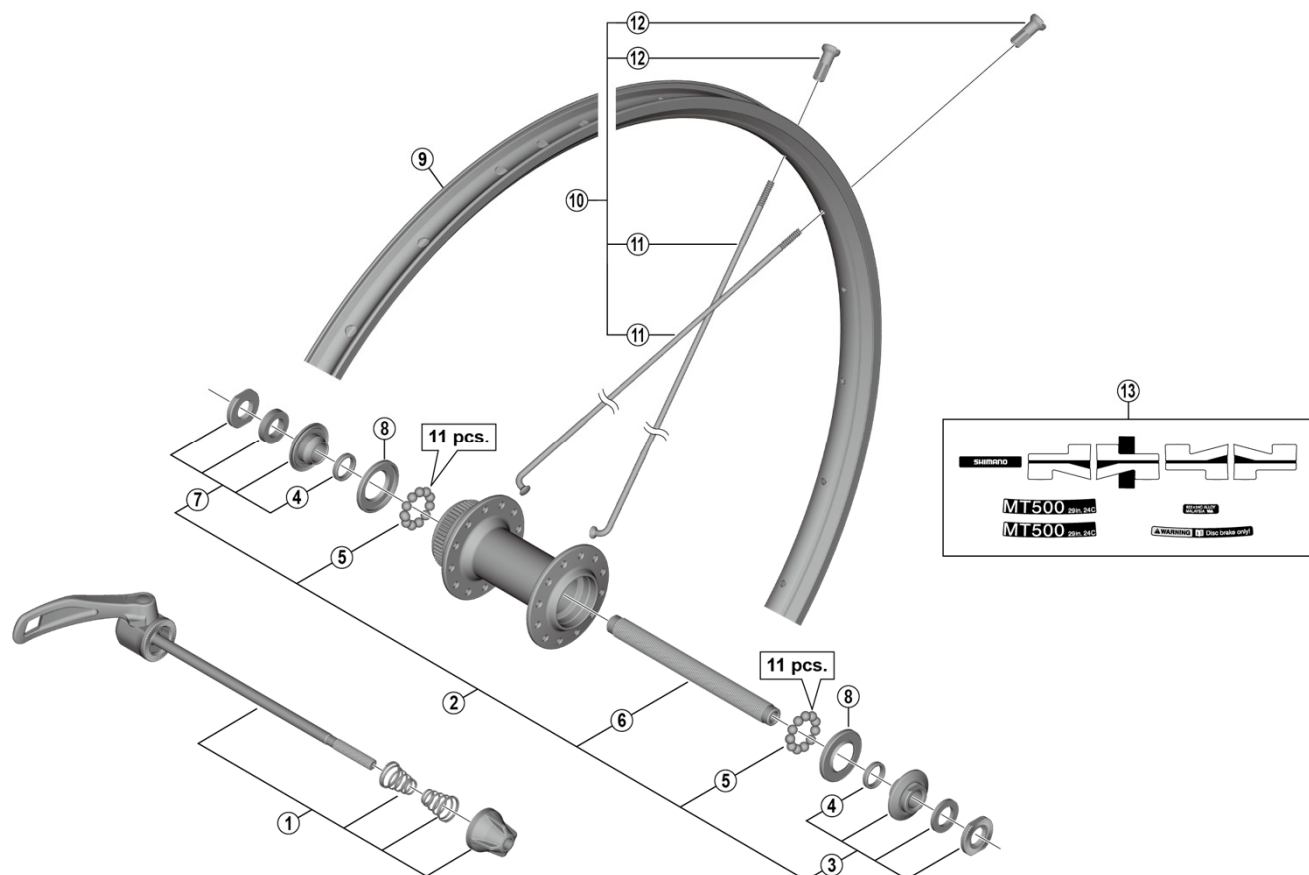

• Over Lock Nut Dimension: 100 mm

ITEM NO.	SHIMANO CODE NO.	DESCRIPTION	INTERCHANGE-ABILITY	
			A	B
1	Y29C98010	Complete quick release 133 mm	A	
2	Y29D98010	Complete hub axle 108 mm		
3	Y2TE98040	Right hand lock nut unit		
4	Y2T804000	O-ring	A	A
5	Y4BB98030	Steel ball (3/16") 22 pcs.	A	A
6	Y25W03000	Hub axle M10 x 108 mm	A	
7	Y29D98020	Left hand lock nut unit		
8	Y2TA06000	Seal ring		
9	-	Rim {24H}		
* 10	EWHSPOKEY274E	Spoke unit {spoke (290 mm x 24 pcs.) / nipple (24 pcs.)}		
11	Y0ERS2000	Spoke (290 mm)		
12	Y012Y3352	Nipple		
13	Y0ER98010	Rim sticker unit		

A: Same parts.

B: Parts are usable, but differ in materials, appearance, finish, size, etc.

Absence of mark indicates non-interchangeability.

Specifications are subject to change without notice.

WH-MT15-CL-F-29

WH-MT35-CL-F-29

Apr.-2021-4318A

© Shimano Inc. I

SHIMANO