

NEXUS 5-speed E-Bike Dedicated DI2 Internal Hub w/Coaster Brake

SG-C7050-5C

MU-UR500 SM-C7050-5 CS-C7000

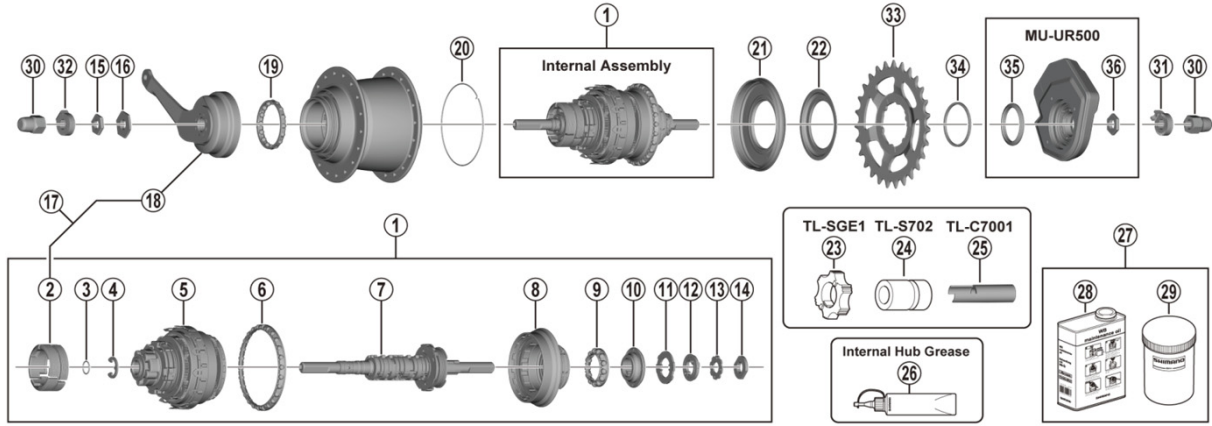

SG-C7050-5D
SG-C6061-8C

| ITEM NO. | SHIMANO CODE NO. | DESCRIPTION | INTERCHANGEABILITY | |
|----------|------------------|---|--------------------|-------------|
| | | | SG-C7050-5D | SG-C6061-8C |
| 1 | Y3FE98010 | Internal Assembly (Axle Length 187 mm) | | |
| 2 | Y37G98020 | Brake Shoe Unit (3 pcs.) | | A |
| 3 | Y37E08000 | O-Ring | | A |
| 4 | Y3FE10000 | E-Ring (D9.6) | | |
| 5 | Y3FE98020 | Carrier Unit | | |
| 6 | Y38X98050 | Ball Retainer O (3/16" x 26) | A | A |
| 7 | Y3FE98030 | Hub Axle Unit (Axle Length 187 mm) | | |
| 8 | Y3FF98040 | Driver Unit | A | |
| 9 | Y3FF98050 | Ball Retainer A (7/32" x 13) | A | |
| 10 | Y3FF98060 | Right Hand Cone w/Seal | A | |
| 11 | Y37S07000 | Drive Plate | A | A |
| 12 | Y37S98050 | Lock Washer | A | A |
| 13 | Y38F17000 | Right Hand Lock Nut Washer | A | A |
| 14 | Y38F16000 | Right Hand Lock Nut (3.7 mm) | A | A |
| 15 | Y35P28000 | Left Hand Lock Nut (3 mm) | | A |
| 16 | Y35P22000 | Stop Nut | | A |
| 17 | Y31N98060 | Brake Shoe Unit & Brake Arm Unit | | A |
| 18 | Y31N98050 | Brake Arm Unit (3 Serration) | | A |
| 19 | Y38R98190 | Ball Retainer B (3/16" x 16) | | A |
| * 20 | Y3FE17000 | Hub Shell Slide Spring | | |
| 21 | Y37G98080 | Right Hand Dust Cap A w/Seal | A | |
| 22 | Y3FF47000 | Right Hand Dust Cap C | A | |
| 23 | Y20W10000 | TL-SGE1 1st Gear Set Tool | A | A |
| 24 | Y13098022 | TL-S702 Right Hand Cone Installation Tool | A | A |
| 25 | Y70821000 | TL-C7001 Right Hand Cone Removal Tool | A | |
| 26 | Y04120800 | Internal Hub Grease (Net. 100g) | A | A |
| 27 | Y00298010 | WB maintenance oil set | A | A |
| 28 | Y00201000 | WB maintenance oil (1L) | A | A |
| 29 | Y00201100 | Bottle | A | A |
| 30 | Y31414010 | Cap Nut (3/8") | A | A |
| 31 | Y33Z20500 | Non-turn Washer 5R (Yellow) | A | A |
| | Y33M39600 | Non-turn Washer 6R (Silver) | A | A |
| | Y33M39700 | Non-turn Washer 7R (Black) | A | A |
| 32 | Y34R85010 | Non-turn Washer 8R (Dark Blue) | A | A |
| | Y33M39510 | Non-turn Washer 5L (Brown) | A | A |
| | Y33M39610 | Non-turn Washer 6L (White) | A | A |
| | Y33M39710 | Non-turn Washer 7L (Gray) | A | A |
| 33 | Y34R85000 | Non-turn Washer 8L (Dark Green) | A | A |
| | Y0FM24000 | Sprocket Wheel 24T (CS-C7000) | A | |
| | Y0FM01000 | Sprocket Wheel 27T (CS-C7000) | A | |
| | Y0FM30000 | Sprocket Wheel 30T (CS-C7000) | A | |
| 34 | Y7ZP04000 | Snap Ring | A | |
| 35 | Y78U00022 | Motor Unit Seal | | |
| 36 | Y707000Y0 | Lock Nut | | |

A: Same parts.

B: Parts are usable, but differ in materials, appearance, finish, size, etc.

Absence of mark indicates non-interchangeability.

Specifications are subject to change without notice.

Jun.-2020-4453C

© Shimano Inc. I

SHIMANO