

GRX Rear Derailleur
RD-RX400 (10-speed)

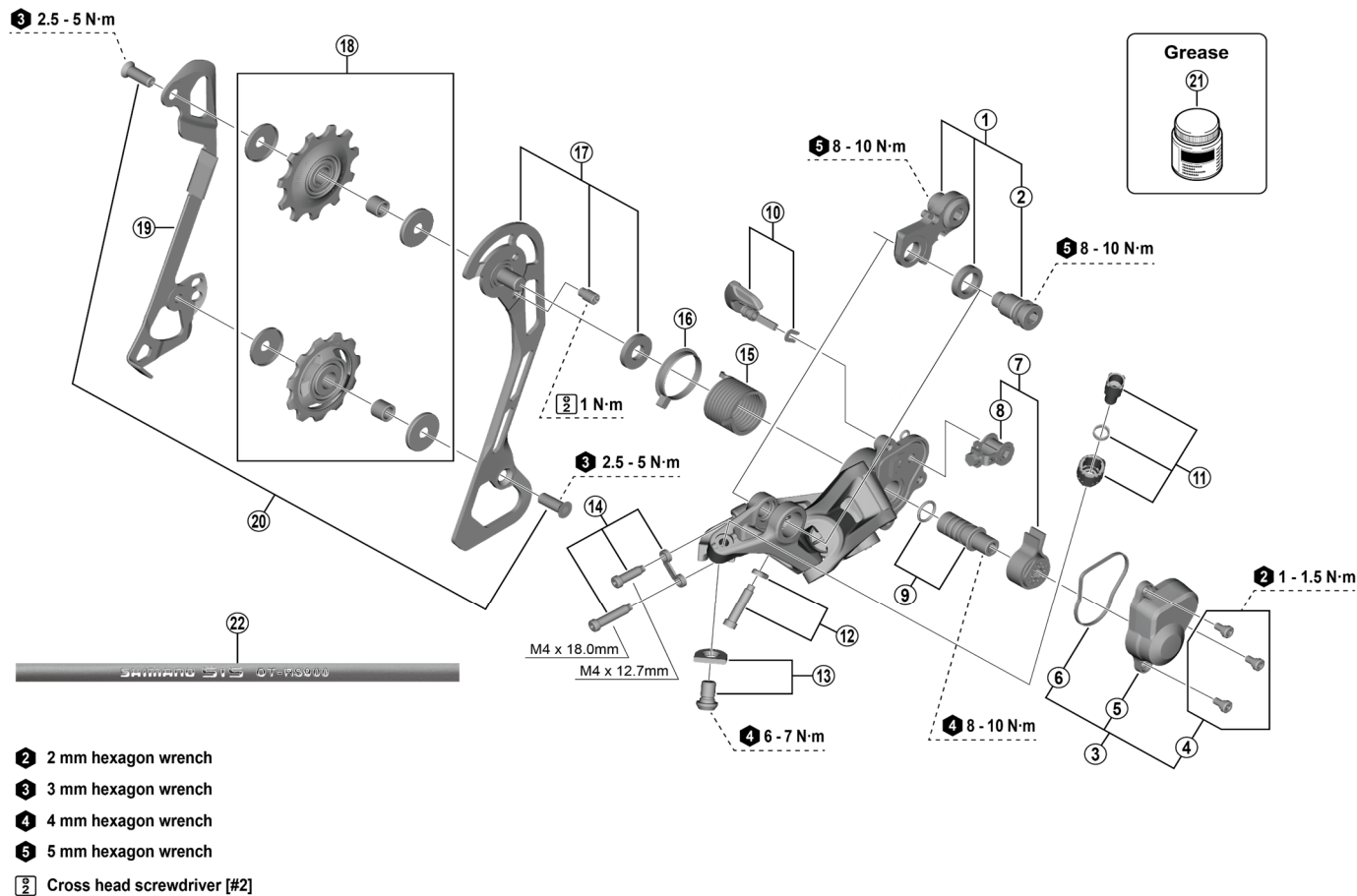

ITEM NO.	SHIMANO CODE NO.	DESCRIPTION
* 1	Y3HY98020	Bracket axle unit
* 2	Y3HY9801T	Bracket axle
3	Y3GE98020	Plate cover unit
4	Y5Y198070	Plate unit cover screw set (3 pcs.)
5	Y3GE41000	Plate unit cover
6	Y3FK41000	Plate unit cover gasket
7	Y3GE98060	Stabilizer unit
8	Y5Y198120	Cam unit
9	Y5PV98060	Plate axle and O-ring
10	Y3GE98030	Switch lever unit and fixing plate
11	Y3F398030	Cable adjustment barrel unit
12	Y3E998040	End adjusting screw (M4 x 18) and plate
13	Y3F398040	Cable fixing screw and plate
14	Y3E998060	Stroke adjusting screws and plate
15	Y5PV17000	Plate tension spring
16	Y5PV24000	P-seal ring
17	Y3GL98020	Outer plate assembly
18	Y3GL98010	Tension and guide pulley set
19	Y3E526000	Inner plate
20	Y5V598140	Pulley screw (2 pcs.)
21	Y04121000	Grease for stabilizer (Net. 50g)
22	Y0BM98011	OT-RS900 (black) 240 mm x 10 pcs. (with sealed outer cap and outer cap with long tongue)
	Y0BM98021	OT-RS900 (white) 240 mm x 10 pcs. (with sealed outer cap and outer cap with long tongue)
	Y0BM98031	OT-RS900 (red) 240 mm x 10 pcs. (with sealed outer cap and outer cap with long tongue)
	Y0BM98041	OT-RS900 (high-tech gray) 240 mm x 10 pcs. (with sealed outer cap and outer cap with long tongue)

Jan.-2024-4576A
© Shimano Inc. I

Specifications are subject to change without notice.
Torque information is listed.