

Front Hub

HB-MT200

For Disc Brake

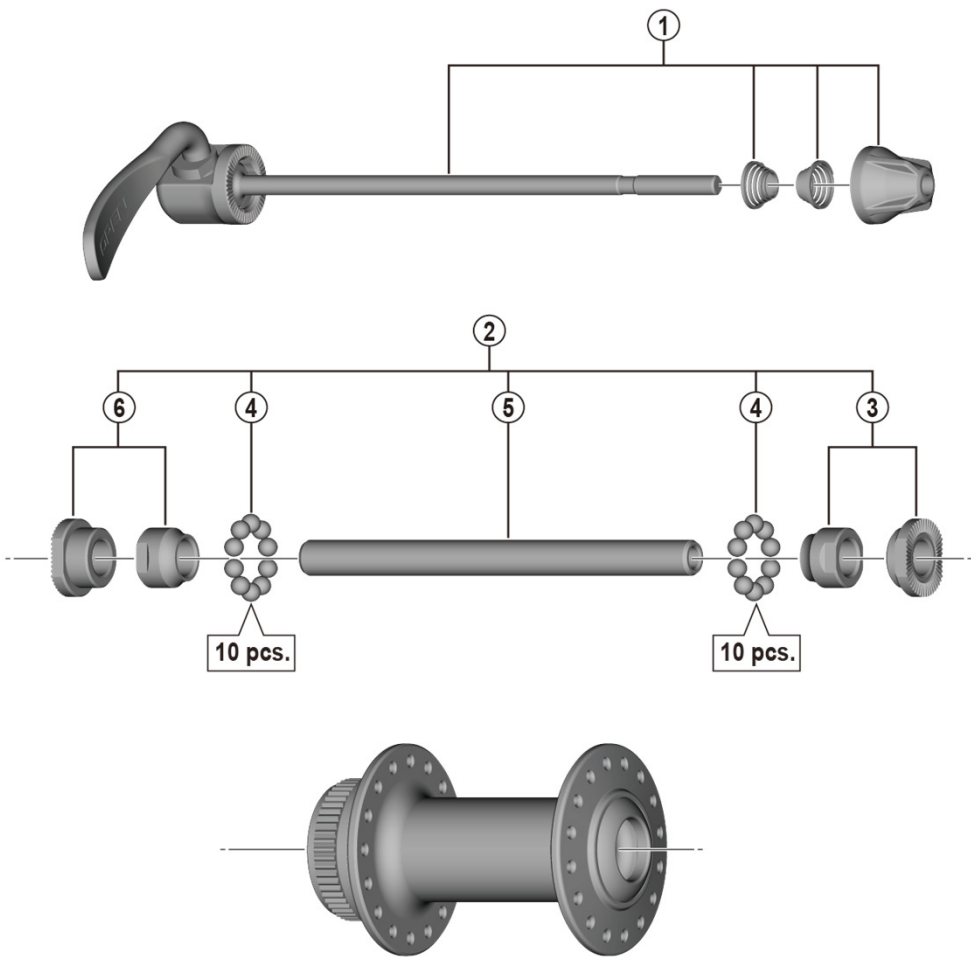

• Over Lock Nut Dimension: 100 mm (3-15/16")

ITEM NO.	SHIMANO CODE NO.	DESCRIPTION	INTERCHANGE-ABILITY		
1	Y2A398010	Complete Quick Release 133 mm (5-1/4")	A		
2	Y2A198010	Complete Hub Axle 108 mm (4-1/4")	A		
3	Y2A198020	Right Hand Lock Nut Unit	A		
4	Y00091210	Steel Ball (3/16") 20 pcs.	A		
5	Y25W03000	Hub Axle M10 x 108 mm (4-1/4")	A		
6	Y2A198030	Left Hand Lock Nut Unit	A		

A: Same parts.

B: Parts are usable, but differ in materials, appearance, finish, size, etc.

Absence of mark indicates non-interchangeability.

Specifications are subject to change without notice.

HB-TX505

Jan.-2018-4360

© Shimano Inc. ITP

SHIMANO