

DEORE Front Hub (For Disc Brake)

# HB-M618 HB-M618-B

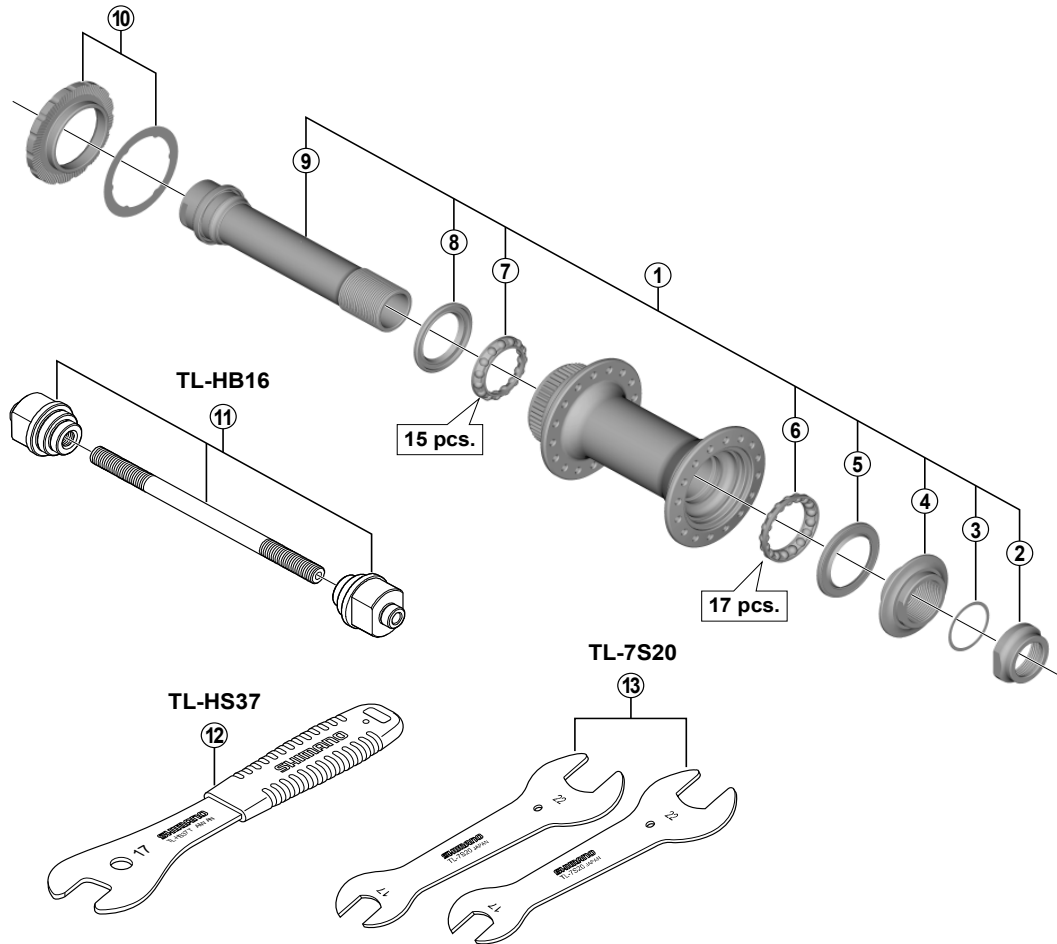

• Over Lock Nut Dimension: 100 mm for HB-M618 / 110 mm for HB-M618-B

ITEM NO.	SHIMANO CODE NO.	DESCRIPTION	INTERCHANGEABILITY		
			HB-M618	HB-M778	HB-M988
1	Y24698010	Complete Hub Axle for HB-M618			
	Y2AJ98010	Complete Hub Axle for HB-M618-B			
2	Y24612000	Right Hand Lock Nut			B
3	Y24613000	Adjusting Spacer			
4	Y24698040	Right Hand Cone w/Dust Cap			
5	Y27X15000	Right Hand Seal Ring			A
6	Y27X98030	Right Hand Ball Retainer (5/32" x 17)			A
7	Y27X98040	Left Hand Ball Retainer (5/32" x 15)			A
8	Y27X14000	Left Hand Seal Ring			A
9	Y24698020	Hub Axle Unit for HB-M618			
	Y2AJ98020	Hub Axle Unit for HB-M618-B			
10	Y24698030	Lock Ring & Washer	B	B	B
11	Y20W98020	TL-HB16 Hub Setting Tool	A	A	A
12	Y23098030	TL-HS37 Hub Spanner (17 mm)			A
13	Y13098900	TL-7S20 Hub Spanner (17 mm x 22 mm) 2 pcs.			A

A: Same parts.

B: Parts are usable, but differ in materials, appearance, finish, size, etc.

Absence of mark indicates non-interchangeability.

May-2020-3517C

© Shimano Inc. I

Specifications are subject to change without notice.

# SHIMANO