

# ALFINE Front Chainwheel FC-S501

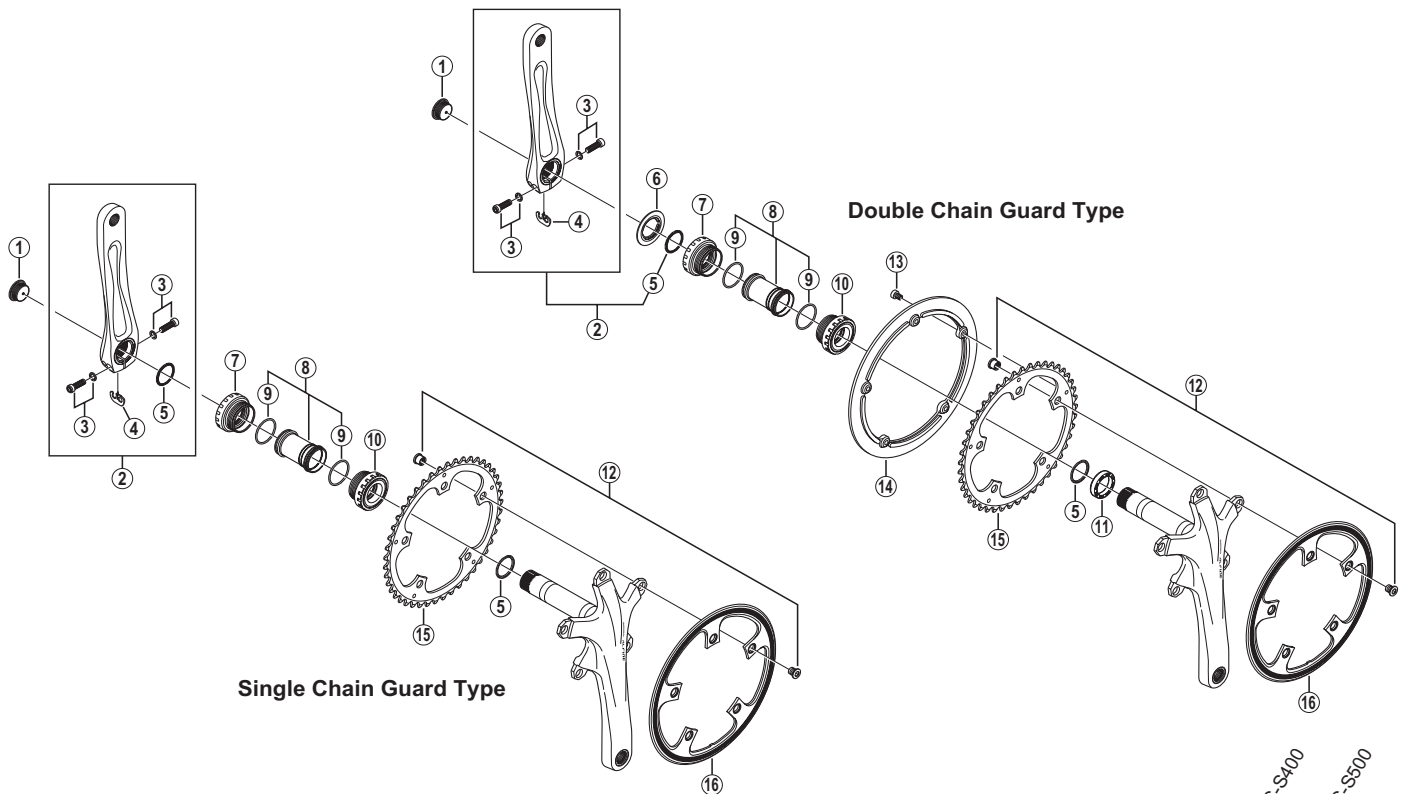

• Bolt circle diameter: 130 mm

ITEM NO.	SHIMANO CODE NO.	DESCRIPTION	INTERCHANGE-ABILITY	
1	Y1KS13000	Crank Arm Fixing Bolt		
2	Y1PB98010	Left Hand Crank Arm 170 mm (Silver)		
	Y1PB98020	Left Hand Crank Arm 170 mm (Black)		
3	Y1KS98030	Clamp Bolt (Silver/M6 x 19) & Washer		A
	Y1HS98060	Clamp Bolt (Black/M6 x 19) & Washer		A
4	Y1GE98050	Plate		A
5	Y1F316000	Ring		A
6	Y1MD14100	Spacer		A
7	Y1MH98050	Left Hand Adapter (B.C.1.37" x 24T) English Thread (SM-BB4600)		B
8	Y1MH98070	Inner Cover & O-Ring		B
9	Y1TF21000	O-Ring		A
10	Y1MH98080	Right Hand Adapter (B.C.1.37" x 24T) English Thread (SM-BB4600)		B
11	Y1F913000	Spacer (6.5 mm)		A
12	Y1HD98020	Gear Fixing Bolt (Silver/M8 x 8.5) & Nut (5 sets)	A	A
	Y1HD98040	Gear Fixing Bolt (Black/M8 x 8.5) & Nut (5 sets)	A	A
13	Y1BA98040	Chain Guard Fixing Bolt (Silver/5 pcs.)	A	A
	Y1HD98050	Chain Guard Fixing Bolt (Black/5 pcs.)	A	A
14	Y1HD64010	Low Guard for 39T	A	A
	Y1PB12000	Low Guard for 42T		
	Y1HD63000	Low Guard for 45T	A	A
15	Y1HD39000	Chainring 39T (Silver) for Double Chain Guard	A	A
	Y1H639000	Chainring 39T (Silver) for Single Chain Guard	A	A
	Y1HD39010	Chainring 39T (Black) for Double Chain Guard	A	A
	Y1HD39110	Chainring 39T (Black) for Single Chain Guard	A	A
	Y1PB42000	Chainring 42T (Silver)		
	Y1PB42010	Chainring 42T (Black)		
	Y1PB45000	Chainring 45T (Silver)	B	B
	Y1PB45010	Chainring 45T (Black)	B	B
16	Y1HD62000	Top Guard (Silver) for 39T	A	A
	Y1HD62010	Top Guard (Black) for 39T	A	A
	Y1PB11000	Top Guard (Silver) for 42T		
	Y1PB11010	Top Guard (Black) for 42T		
	Y1HD61000	Top Guard (Silver) for 45T	A	A
	Y1HD61010	Top Guard (Black) for 45T	A	A

A: Same parts.

B: Parts are usable, but differ in materials, appearance, finish, size, etc.

Absence of mark indicates non-interchangeability.

Sep.-2013-3475  
© Shimano Inc. I

Specifications are subject to change without notice.

# SHIMANO