

DURA-ACE Crankset FC-R9200 BB-R9100

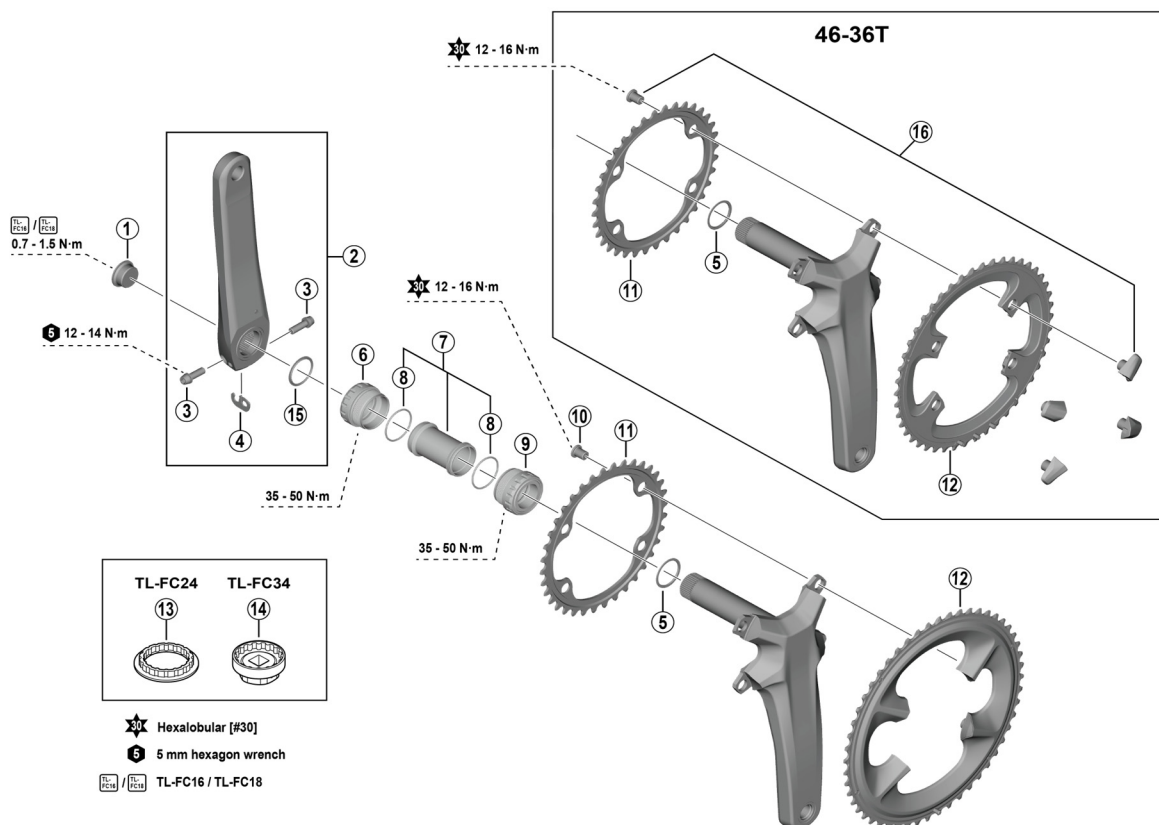

• Chaining teeth combinations: 46-36T/50-34T/52-36T/54-40T

• P.C.D. 110 mm

FC-R9100

ITEM NO.	SHIMANO CODE NO.	DESCRIPTION	INTERCHANGEABILITY	
1	Y1KY08000	Crank mounting screw		
2	Y0MZ98040	Left-hand crank arm unit 160 mm		
	Y0MZ98050	Left-hand crank arm unit 165 mm		
	Y0MZ98060	Left-hand crank arm unit 167.5 mm		
	Y0MZ98070	Left-hand crank arm unit 170 mm		
	Y0MZ98080	Left-hand crank arm unit 172.5 mm		
	Y0MZ98090	Left-hand crank arm unit 175 mm		
Y0MZ98100	Left-hand crank arm unit 177.5 mm			
3	Y1GS22100	Crank fixing screw (M6 x 19) with washer		
4	Y1GE98050	Plate	A	
5	Y0MZ14000	Ring R		
6	Y1VR98010	Left-hand cup (B.C.1.37" x 24T) english thread (BB-R9100)	A	
	Y1VR98020	Left-hand cup (M36 x 24T) italian thread (BB-R9100)	A	
7	Y1KY98130	Inner cover and O-ring	A	
8	Y1TF21000	O-ring		
9	Y1VR98030	Right-hand cup (B.C.1.37" x 24T) english thread (BB-R9100)	A	
	Y1VR98040	Right-hand cup (M36 x 24T) italian thread (BB-R9100)	A	
10	Y1H598160	Chainring fixing screw (M8 x 10.1 / 1 unit = 4 pcs.)	A	
11	Y0MZ34000	Chainring 34T-NK		
	Y0MZ36000	Chainring 36T-NH		
	Y0MZ40000	Chainring 40T-NJ		
12	Y0MZ98110	Chainring 46T-NH		
	Y0MZ98010	Chainring 50T-NK		
	Y0MZ98020	Chainring 52T-NH		
Y0MZ98030	Chainring 54T-NJ			
13	Y13009240	TL-FC24 Bottom bracket cup tool		
14	Y13009250	TL-FC34 Bottom bracket cup tool		
* 15	Y0MZ9801T	Ring L		
* 16	Y0MZ98120	46-36T Chainring fixing bolt (M8 x 10.1 / 1 unit = 4 pcs.) and nut (1 unit = 4 pcs.)		

A: Same parts.

B: Parts are usable, but differ in materials, appearance, finish, size, etc.

Absence of mark indicates non-interchangeability.

Specifications are subject to change without notice.

Torque information is listed.

Nov.-2023-4809A

© Shimano Inc. I

SHIMANO