

# SLX Cassette Sprocket CS-M7000 (11-speed)

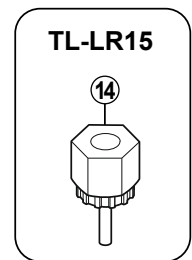
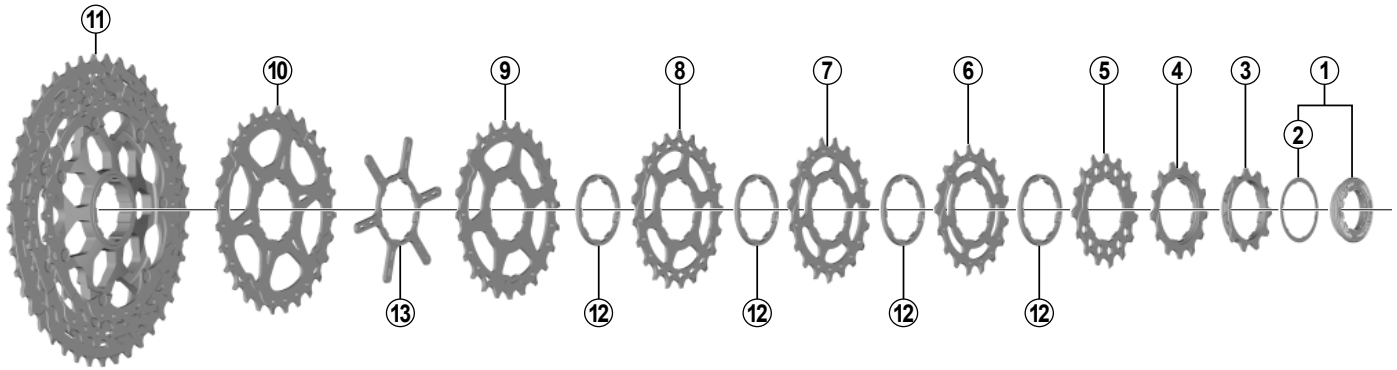

- 11-40T sprocket teeth combination: 11-13-15-17-19-21-24-27-31-35-40T
- 11-42T sprocket teeth combination: 11-13-15-17-19-21-24-28-32-37-42T
- 11-46T sprocket teeth combination: 11-13-15-17-19-21-24-28-32-37-46T

CS-M8000

ITEM NO.	SHIMANO CODE NO.	DESCRIPTION	INTERCHANGEABILITY	
1	Y1VN98010	Lock Ring & Spacer	A	
2	Y10Z04000	Lock Ring Spacer	A	
3	Y1RK11000	Sprocket Wheel 11T (Built in spacer type)	A	
4	Y1RK13000	Sprocket Wheel 13T (Built in spacer type)	A	
5	Y1RK15000	Sprocket Wheel 15T	A	
6	Y1RK17000	Sprocket Wheel 17T	A	
7	Y1RK19000	Sprocket Wheel 19T	A	
8	Y1VN21000	Sprocket Wheel 21T		
9	Y1VN24000	Sprocket Wheel 24T		
10	Y1VN27000	Sprocket Wheel 27T for 11-40T		
	Y1VN28000	Sprocket Wheel 28T for 11-42T / 11-46T		
11	Y1VN98020	Sprocket Unit (31-35-40T) for 11-40T		
	Y1VN98030	Sprocket Unit (32-37-42T) for 11-42T		
	Y1VN98040	Sprocket Unit (32-37-46T) for 11-46T		
12	Y1VN05000	Sprocket Spacer (t=2.18 mm)	A	
13	Y1VN02000	Spacer		
14	Y12009230	Lock Ring Removal Tool (TL-LR15)	A	

A: Same parts.

B: Parts are usable, but differ in materials, appearance, finish, size, etc.

Absence of mark indicates non-interchangeability.

Specifications are subject to change without notice.

Apr.-2017-3984A

© Shimano Inc. I

# SHIMANO