

Tourney TX Disc Brake

BR-TX805

Brake Caliper

SM-RT30

SM-RT20

Disc Rotor

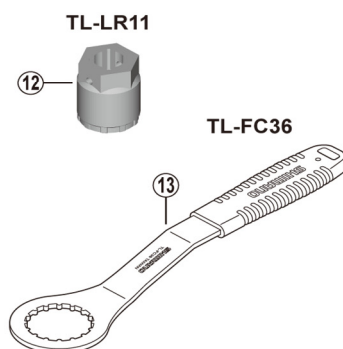
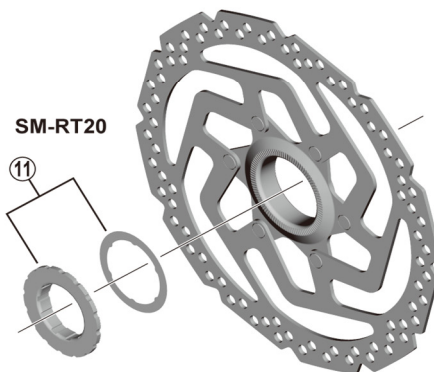
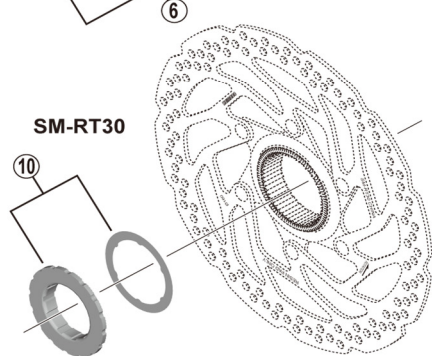
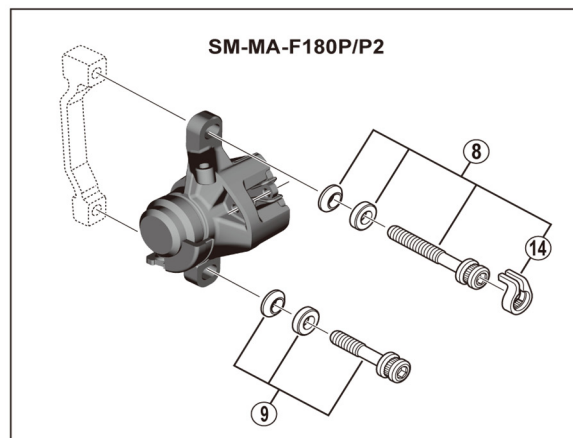
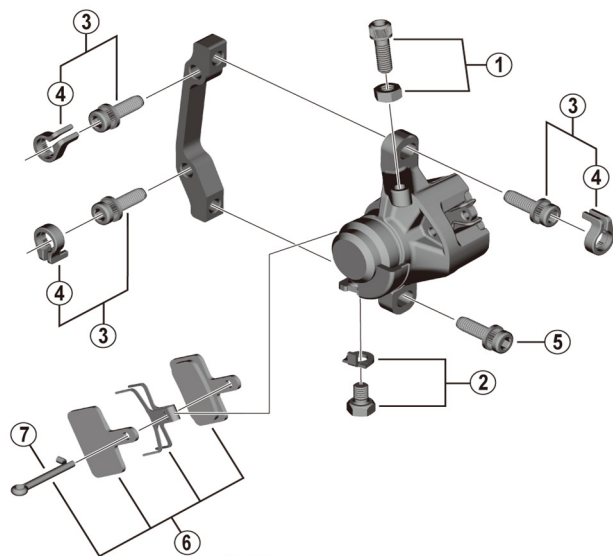

ITEM NO.	SHIMANO CODE NO.	DESCRIPTION	INTERCHANGEABILITY		
1	Y8JW98010	Cable adjusting bolt and nut	A		
2	Y8JW98020	Cable fixing screw (M6 x 9) and plate	A		
3	Y2F398020	Caliper fixing screw (M6 x 18.7) and snap ring	A		
4	Y2RT06000	Snap ring	A		
5	Y8C509020	Caliper fixing screw (M6 x 18.7)	A		
*	EBPB05SRXA	B05S-RX Resin pad and spring with split pin 3 type (pair)	A		
* 6	EBPB05SRXBS	B05S-RX Resin pad and spring with split pin 3 type (25 pairs)	A		
*	EBPB05SRXCS	B05S-RX Resin pad and spring with split pin 3 type (50 pairs)	A		
7	Y8C505000	Split pin	A		
8	Y2RT98020	Caliper fixing screw unit (M6 x 37.9)			
9	Y8G498030	Caliper fixing screw unit (M6 x 32.1)	A		
10	Y8JX98020	Lock ring (black) and washer			
11	Y8PW98020	Lock ring and washer	A		
12	Y8PW04100	TL-LR11 Lock ring removal tool			
13	Y13098000	TL-FC36 Lock ring removal tool	A		
14	Y2RT07000	Snap ring			

A: Same parts.

B: Parts are usable, but differ in materials, appearance, finish, size, etc.

Absence of mark indicates non-interchangeability.

Specifications are subject to change without notice.

Dec.-2021-3753G

© Shimano Inc. I

SHIMANO