

DEORE Disc Brake
BR-T615 Brake Caliper
SM-BH59 Brake Hose

SM-RT54 Disc Rotor/Center Lock
SM-RT56 Disc Rotor/6-Bolt

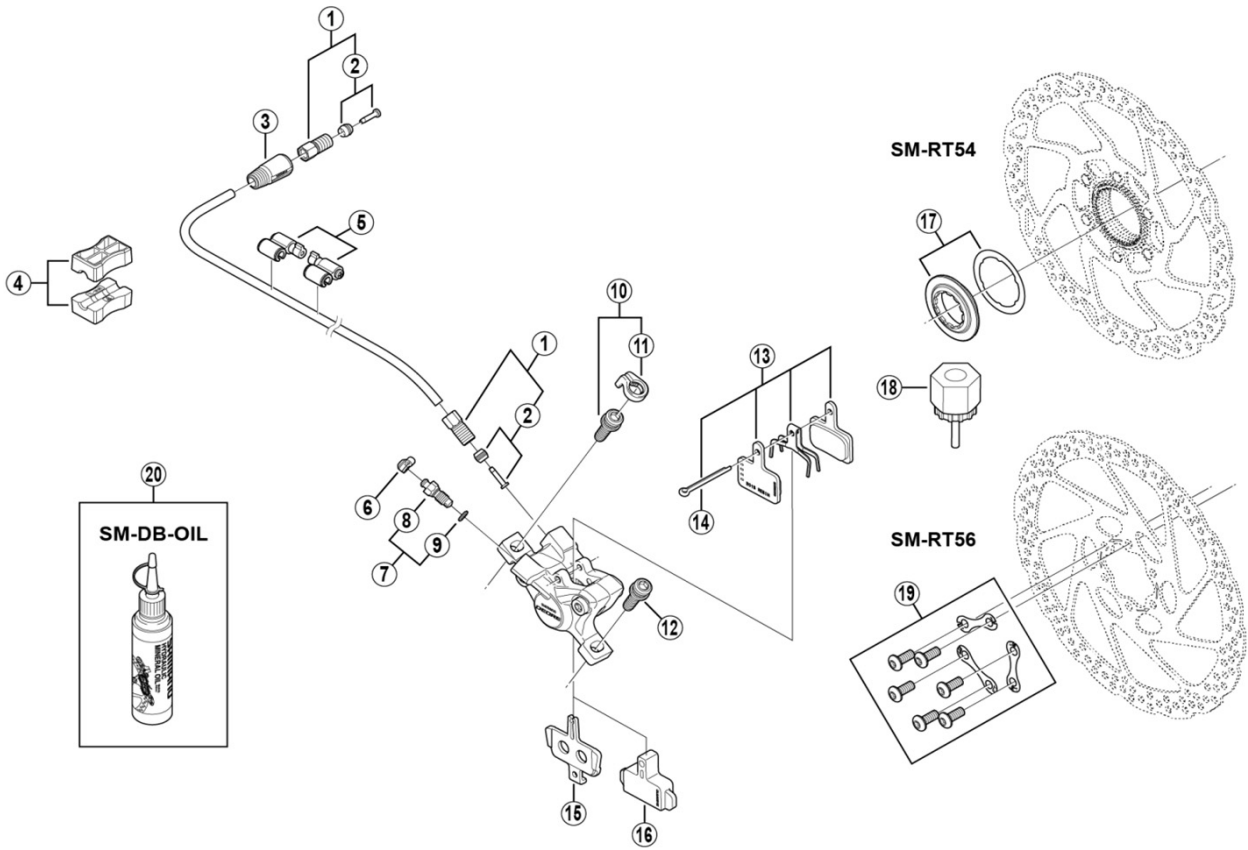

BR-T615

ITEM NO.	SHIMANO CODE NO.	DESCRIPTION	INTERCHANGEABILITY	
1	Y8H298010	Flare Nut Unit		
2	Y8H298020	Olive and Connector Insert		
3	Y8H203010	Cover		
4	Y8H198030	TL-BH61 Shimano original tool (2 pcs.)	A	
5	Y83098040	SM-HANG Hose Supporter A and B		
6	Y8B214000	Bleed Nipple Cap	A	
7	Y8ES98020	Bleed Nipple and Seal Ring	A	
8	Y8CL24100	Bleed Nipple	A	
9	Y8B511000	O-Ring for Bleed Nipple	A	
* 10	Y2F398020	Caliper Fixing Screw (M6 x 18.7) and Snap Ring	A	
* 11	Y2RT06000	Snap Ring	A	
12	Y8C509020	Caliper Fixing Screw (M6 x 18.7)	A	
* 13	EBPB01SRESINA	B01S Resin Pad and Spring with Split Pin 3 Type	A	
* 14	Y8DB06100	Split Pin	A	
15	Y8J506000	Pad Spacer	A	
16	Y8FZ05000	Bleeding Spacer	A	
17	Y8K998010	Lock Ring and Washer	A	
18	Y12009230	TL-LR15 Lock Ring Removal Tool	A	
19	Y8KT98010	Rotor Fixing Screw and Lock Washer		
* 20	Y83998020	Mineral Oil (100 ml)	A	
* 20	Y83998030	Mineral Oil (500 ml)	A	

A: Same parts.

B: Parts are usable, but differ in materials, appearance, finish, size, etc.

Absence of mark indicates non-interchangeability.

Specifications are subject to change without notice.

Aug.-2020-3502A

© Shimano Inc. I

SHIMANO