

# SHIMANO 105 Caliper Brake

## BR-R7000 Black / Silver

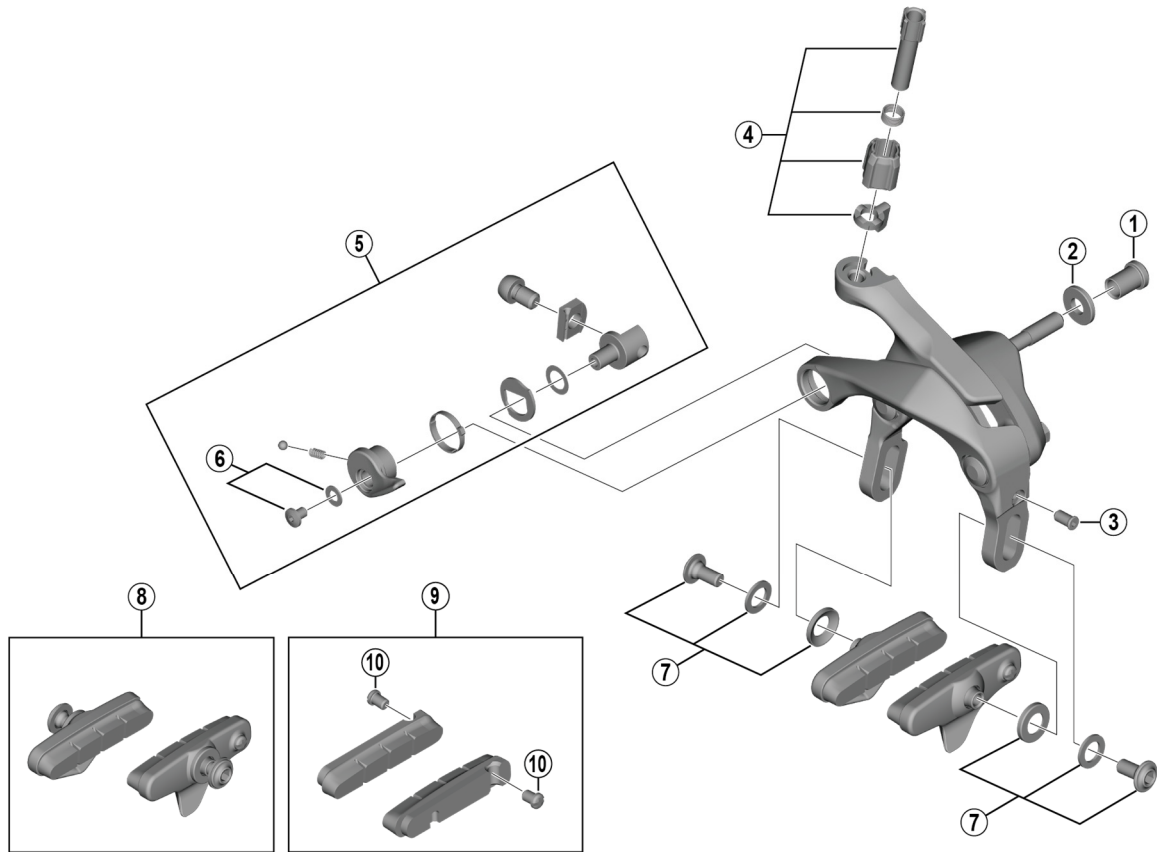

BR-R8000

ITEM NO.	SHIMANO CODE NO.	DESCRIPTION	INTERCHANGEABILITY	
1	Y85575110	Pivot Nut (10.5 mm) for Front / Rear	B	
	Y85575020	Pivot Nut (12.5 mm) for Front	B	
	Y85574010	Pivot Nut (18.0 mm) for Front	B	
	Y8A023000	Pivot Nut (27.0 mm) for Front	B	
	Y8A023300	Pivot Nut (32.0 mm) for Front	B	
2	Y85850120	Set Washer	A	
3	Y8PP09000	EC-Bolt	A	
4	Y8ZJ98020	Cable Adjusting Bolt Unit		
5	Y8ZJ98030	Quick Release Assembly		
6	Y8PP98030	Quick Release Fixing Bolt & Washer	A	
7	Y8G698090	Shoe Fixing Bolt Unit (M5 x 11.2)	A	
8	Y88T98020	R55C4 Cartridge-Type Brake Shoe Set (Pair/Black)	B	
	Y8ZJ98010	R55C4 Cartridge-Type Brake Shoe Set (Pair/Silver)	B	
9	Y8L298060	R55C4 Cartridge-Type Brake Shoes & Fixing Bolts (Pair)	B	
	Y8L298070	R55C4 Cartridge-Type Brake Shoes & Fixing Bolts (Pair) for Carbon Rim	B	
	Y8PP98060	R55C4-A Cartridge-Type Brake Shoes (-1 mm thinner shoe) & Fixing Bolts (Pair) for Carbon Rim	B	
10	Y8L227000	Fixing Bolt (M4 x 5.5)	B	

A: Same parts.

B: Parts are usable, but differ in materials, appearance, finish, size, etc.

Absence of mark indicates non-interchangeability.

Specifications are subject to change without notice.

Apr.-2018-4325

© Shimano Inc. I

# SHIMANO