

DXR V-BRAKE Brake
BR-MX70

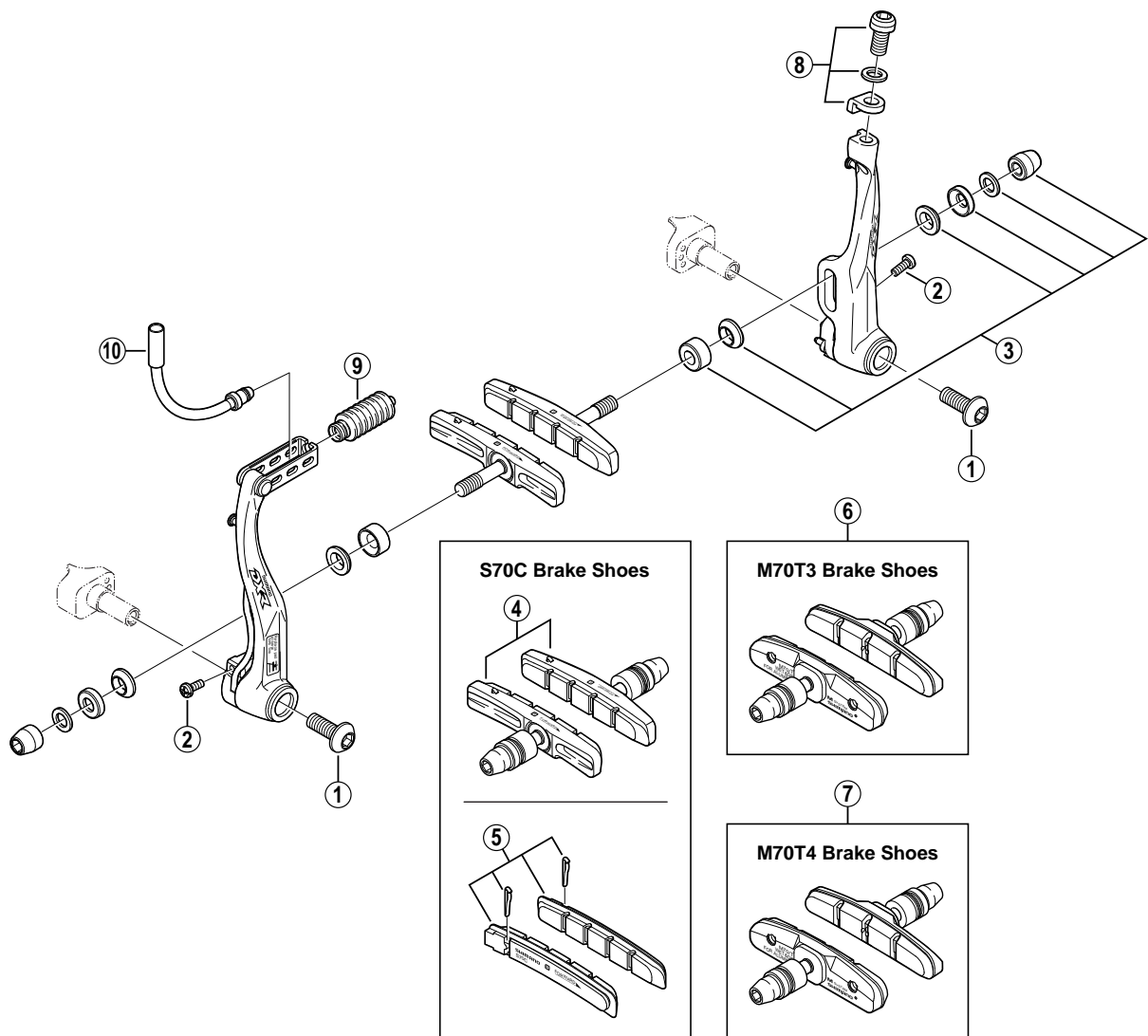

BR-M580

ITEM NO.	SHIMANO CODE NO.	DESCRIPTION	INTERCHANGE-ABILITY
1	Y-8DA 04000	Link Fixing Bolt (M6 x 16)	A
2	Y-8GV 05000	Spring Tension Adjustment Screw (M3 x 8)	A
3	Y-8DA 98020	Shoe Fixing Nut Unit	A
4	Y-8DA 9801A	S70C Cartridge-Type Brake Shoe Set (Pair)	A
5	Y-8AA 98130	S70C Cartridge-Type Brake Shoes & Fixing Pins (Pair)	A
6	Y-8BM9810A	M70T3 Brake Shoe Set (Pair)	A
7	Y-8BM9803A	M70T4 Brake Shoe Set (Pair)	A
8	Y-8BV 98020	Cable Fixing Bolt Unit (M6 x 11.5)	A
9	Y-8BP 14000	Boot	A
10	Y-8AA 98070	Inner Cable Lead Unit (90°: Middle)	A
	Y-8AA 98080	Inner Cable Lead Unit (135°: Long)	A
	Y-8AA 98120	Inner Cable Lead Unit (45°: Short)	A

A: Same parts.
B: Parts are usable, but differ in materials, appearance, finish, size, etc.
Absence of mark indicates non-interchangeability.

0611-2659

Specifications are subject to change without notice.

SHIMANO