

Disc Brake

**BR-M447** Brake Caliper  
**SM-BH59** Brake Hose

**SM-RT54** Disc Rotor/Center Lock  
**SM-RT56** Disc Rotor/6-Bolt

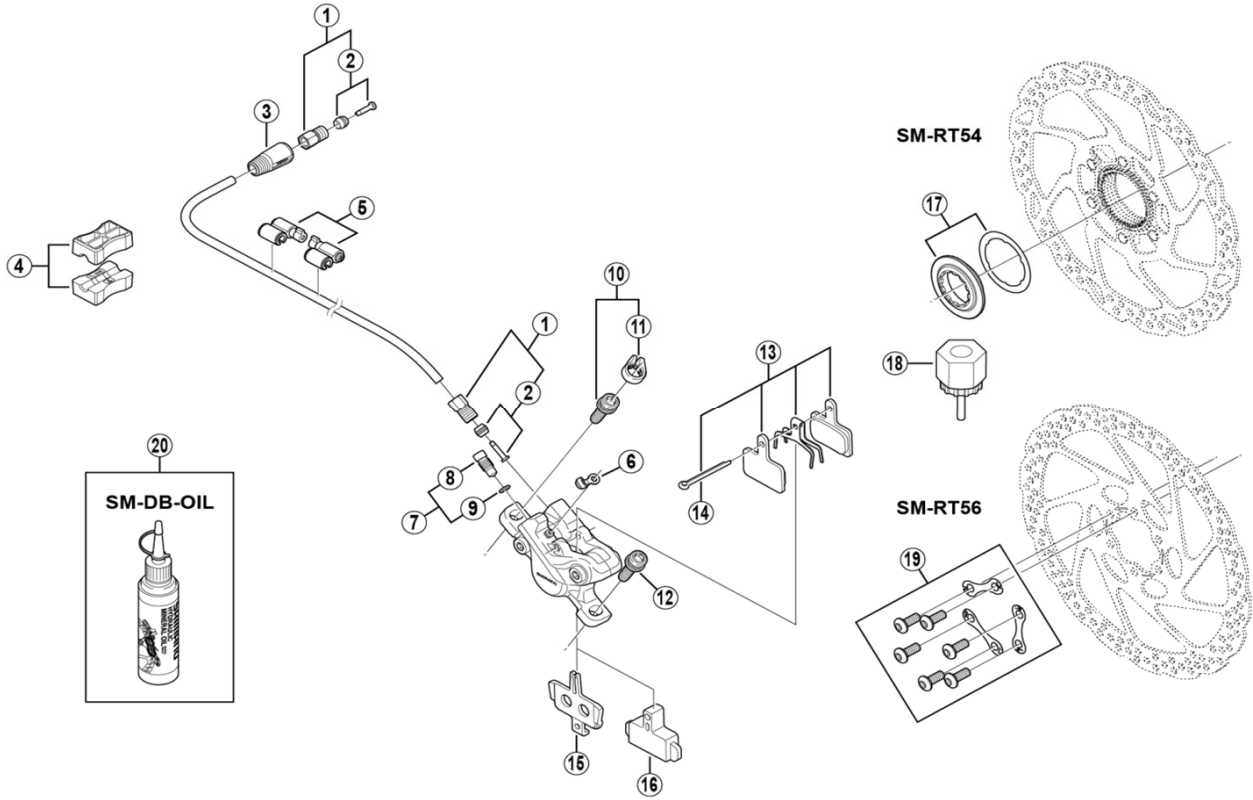

BR-M395

ITEM NO.	SHIMANO CODE NO.	DESCRIPTION	INTERCHANGEABILITY
1	Y8H598010	Flare Nut Unit	A
2	Y8H298020	Olive and Connector Insert	A
3	Y8H203210	Cover	A
4	Y8H198030	TL-BH61 Shimano original tool (2 pcs.)	A
5	Y83098040	SM-HANG Hose Supporter A and B	A
6	Y8B214000	Bleed Nipple Cap	A
7	Y8VZ98010	Bleed Screw and O-Ring	A
8	Y8VZ07000	Bleed Screw	A
9	Y8B511000	O-Ring	A
* 10	Y2F398020	Caliper Fixing Screw (M6 x 18.7) and Snap Ring	A
* 11	Y2RT06000	Snap Ring	A
12	Y8C509020	Caliper Fixing Screw (M6 x 18.7)	A
* 13	EBPB01SRESINA	B01S Resin Pad and Spring with Split Pin 3 Type	A
* 14	Y8DB06100	Split Pin	A
15	Y8J506000	Pad Spacer	A
16	Y8FZ05000	Bleeding Spacer	A
17	Y8K998010	Lock Ring and Washer	A
18	Y12009230	TL-LR15 Lock Ring Removal Tool	A
19	Y8KT98010	Rotor Fixing Screw and Lock Washer	A
* 20	Y83998020	Mineral Oil (100 ml)	A
* 20	Y83998030	Mineral Oil (500 ml)	A

A: Same parts.

B: Parts are usable, but differ in materials, appearance, finish, size, etc.

Absence of mark indicates non-interchangeability.

Specifications are subject to change without notice.

Aug.-2020-3638A

© Shimano Inc. I

**SHIMANO**