

Disc Brake
BR-M355 Brake Caliper
SM-BH59 Brake Hose

SM-RT54 Disc Rotor/Center Lock
SM-RT56 Disc Rotor/6-Bolt

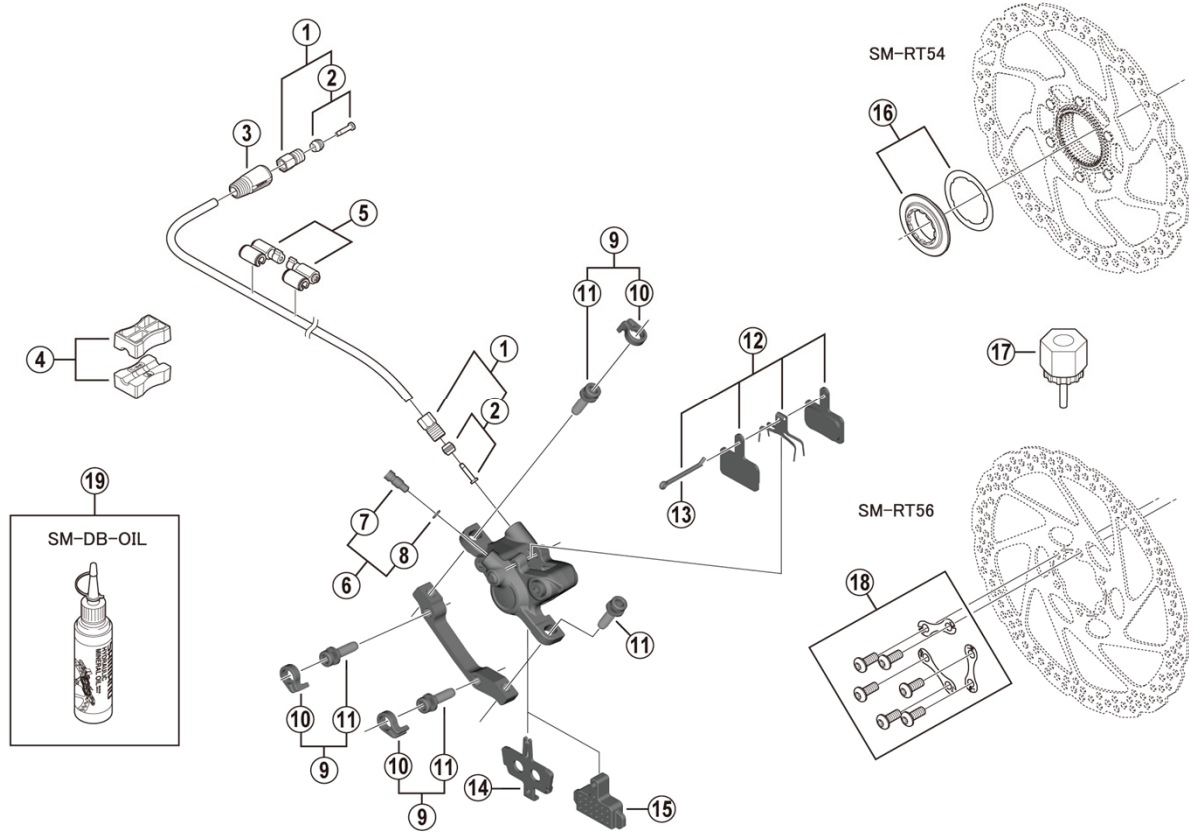

ITEM NO.	SHIMANO CODE NO.	DESCRIPTION
1	Y8AL98020	Flare Nut Unit
2	Y8H298040	Olive & Connector Insert
3	Y8H203210	Cover
4	Y8H198030	TL-BH61 Shimano original tool (2 pcs.)
5	Y83098040	SM-HANG Hose Supporter A & B
6	Y8VZ98010	Bleed Screw & O-Ring
7	Y8VZ07000	Bleed Screw
8	Y8B511000	O-Ring
* 9	Y2F398020	Caliper Fixing Screw (M6 x 18.7) & Snap Ring
* 10	Y2RT06000	Snap Ring
11	Y8C509020	Caliper Fixing Screw (M6 x 18.7)
* 12	EBPB01SRESINA	Resin Pad (B01S) & Spring w/Split Pin 3 Type
* 13	Y8DB06200	Split Pin
14	Y8J506000	Pad Spacer
15	Y8FZ05000	Bleeding Spacer
16	Y8K998010	Lock Ring & Washer
17	Y12009230	TL-LR15 Lock Ring Removal Tool
18	Y8KT98010	Rotor Fixing Screw & Lock Washer
* 19	Y83998020	Mineral Oil (100 ml)
* 19	Y83998030	Mineral Oil (500 ml)

Jul.-2020-3813A
 © Shimano Inc. I

Specifications are subject to change without notice.

SHIMANO